

NANCY & ED JACKMAN PERFORMANCE CENTRE

VENUE DATA SHEET Version #1.4

Located at:

877 YONGE

OPERATED BY NIGHTWOOD THEATRE & TAPESTRY OPERA



LAND ACKNOWLEDGEMENT

We acknowledge that the land on which Nancy & Ed Jackman Performance Centre creates and gathers is the traditional territory of the Mississaugas of the Credit, the Anishnabeg, the Chippewa, the Haudenosaunee, and the Wendat peoples. Known as Tkarón:to, a Mohawk word meaning “the place in the water where the trees are standing,” this land has been cared for by Indigenous peoples for thousands of years and remains home to diverse First Nations, Inuit, and Métis communities.

This land is governed by Treaty 13, also known as the Toronto Purchase, and the Dish With One Spoon Wampum covenant, agreements that emphasize shared responsibility to care for the land and live in harmony.

Acknowledging this truth reminds us of the connections and disconnections inherent in our histories. Inspired by the Truth and Reconciliation Commission, we commit to questioning the narratives we inherit and fostering accountability, equity, and care in all we do.

ADDRESS

Our Venue is located at:

877 Yonge St, Toronto, ON M4W 3M2

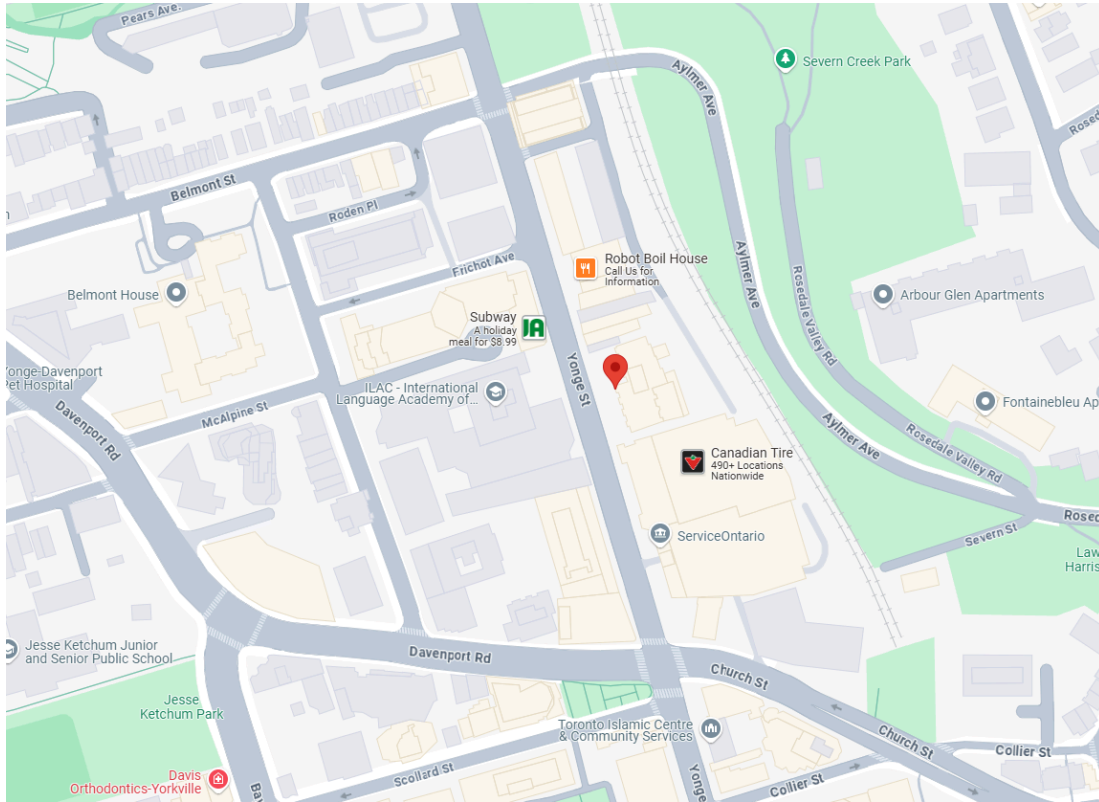

CONTACT

Please direct venue related questions to:

Director of Production and Facilities - **Pip Bradford** - pip@nightwoodtheatre.net

ACCESS & KEYS

ACCESSIBILITY

Nancy & Ed Jackman Performance Centre is accessible to people using mobility aids and devices by ground level access via St. Clare's Multifaith Housing entrance. There are elevators just beyond the security desk that gives access to basement level.

LOADING IN & OUT

TRUCKING IS A CHALLENGE AT 877. NO TRUCKS LARGER THAN ~ 20 ft (5 ton) WILL HAVE ACCESS. MAX Height on North Parking Ramp is 12ft.

ALL Large Trucks load in off the street.

Vans and Pickup Trucks (CONFIRM HEIGHT OF PARKING GARAGE) may unload (sub 15 min) in the parking garage.

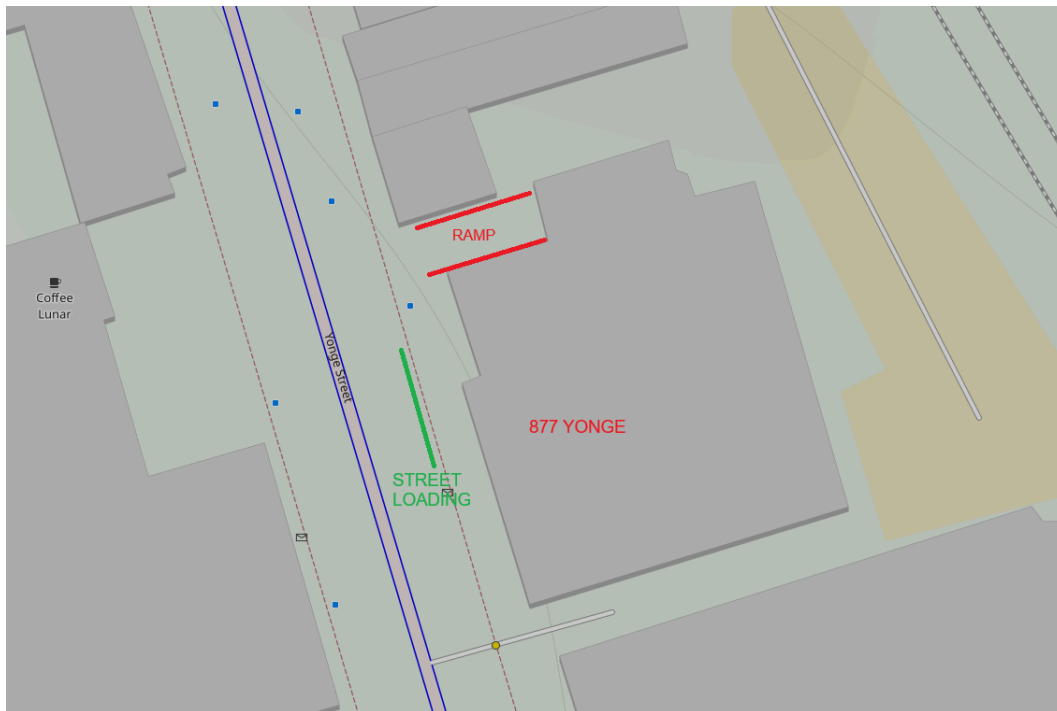

PARKING

No Parking is provided by NEJPC

Municipal street parking may be available on Yonge or South on Davenport.

There is a Private Lot South on Yonge @ Canadian Tire - \$30/day

There is a Surface Lot one block West on McMurich Street - \$20/day

SECURITY

Due to public access inside of 877 Yonge, many doors at NEJPC may be locked. Please let venue staff know what rooms you may need access to.

NEJPC is under video surveillance by St. Clare's Multifaith Housing and potentially 3rd party security firms.

VENUE OVERVIEW

NEJPC is a multidisciplinary venue anchored by a 1,900 sq ft studio venue.

Capacity: Depending on the configuration, the theatre/main space has a 200-person capacity accommodating 90-144 seated on risers. It is also ideal for rehearsing for a larger stage. The flexibility of seating (modular and removable) provides great versatility.

PERFORMANCE HALL

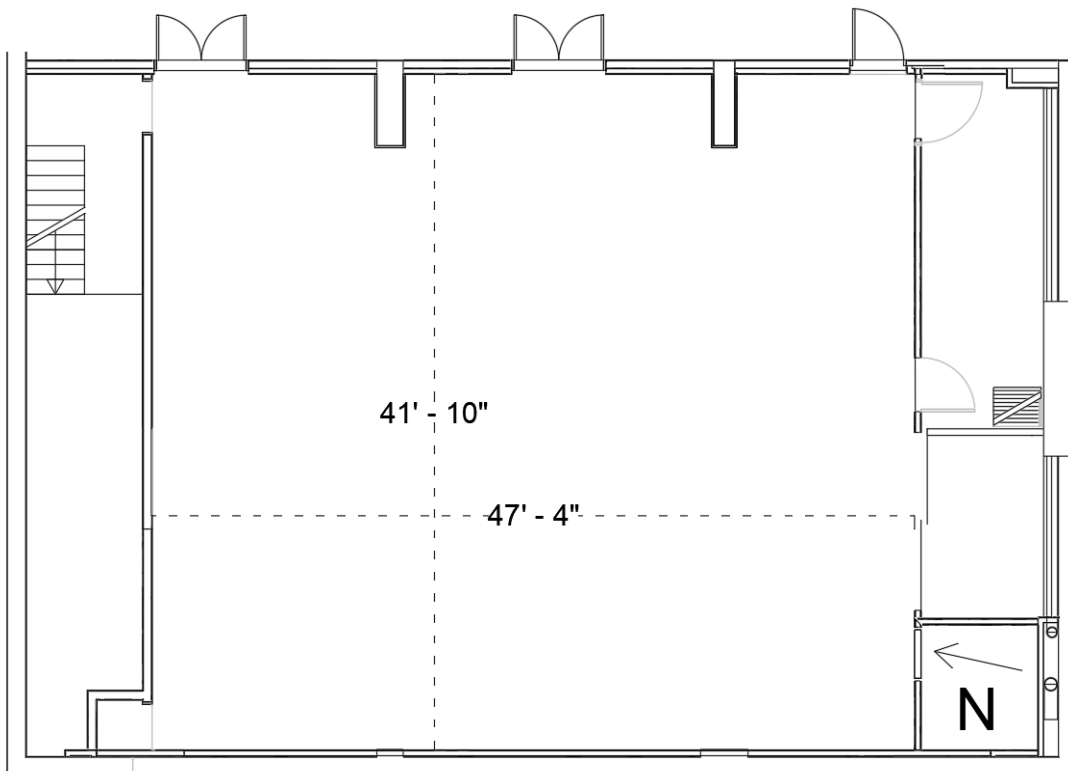

GRID

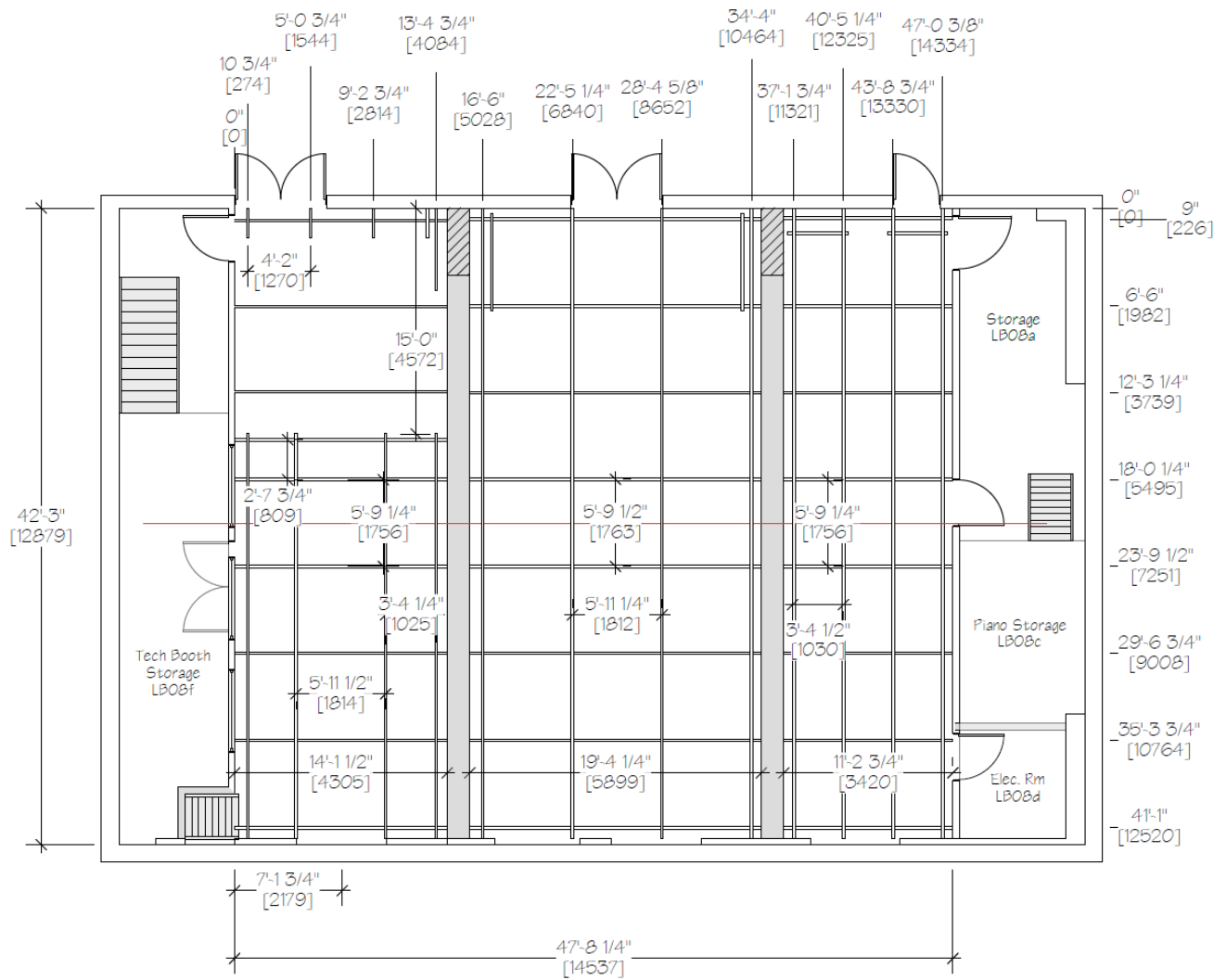

The Grid is ~13' above the finished floor. (North is LEFT side of drawing above)

Underside of North/South pipes @ 12' - 11 1/2"

Underside of East/West pipes @ 13' - 01 1/2"

STAGING LAYOUTS

The following drawings depict several but not all potential seating arrangements possible at NEJPC

Portrait is the standard seating array. Unless otherwise arranged with the Director for Production and Facility both removal and reinstatement of Portrait will be paid for by renter/user group.

PORTRAIT

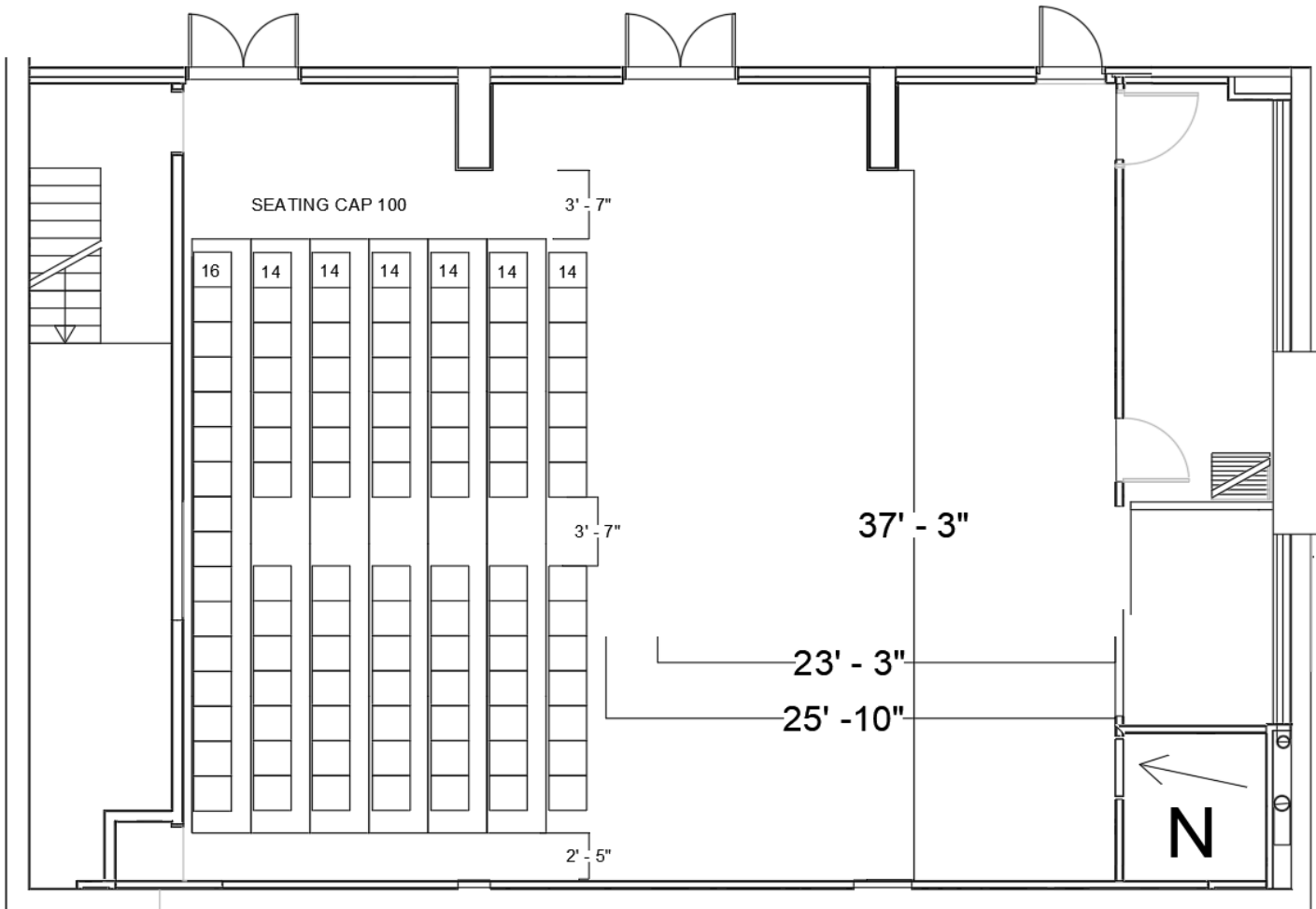

LANDSCAPE

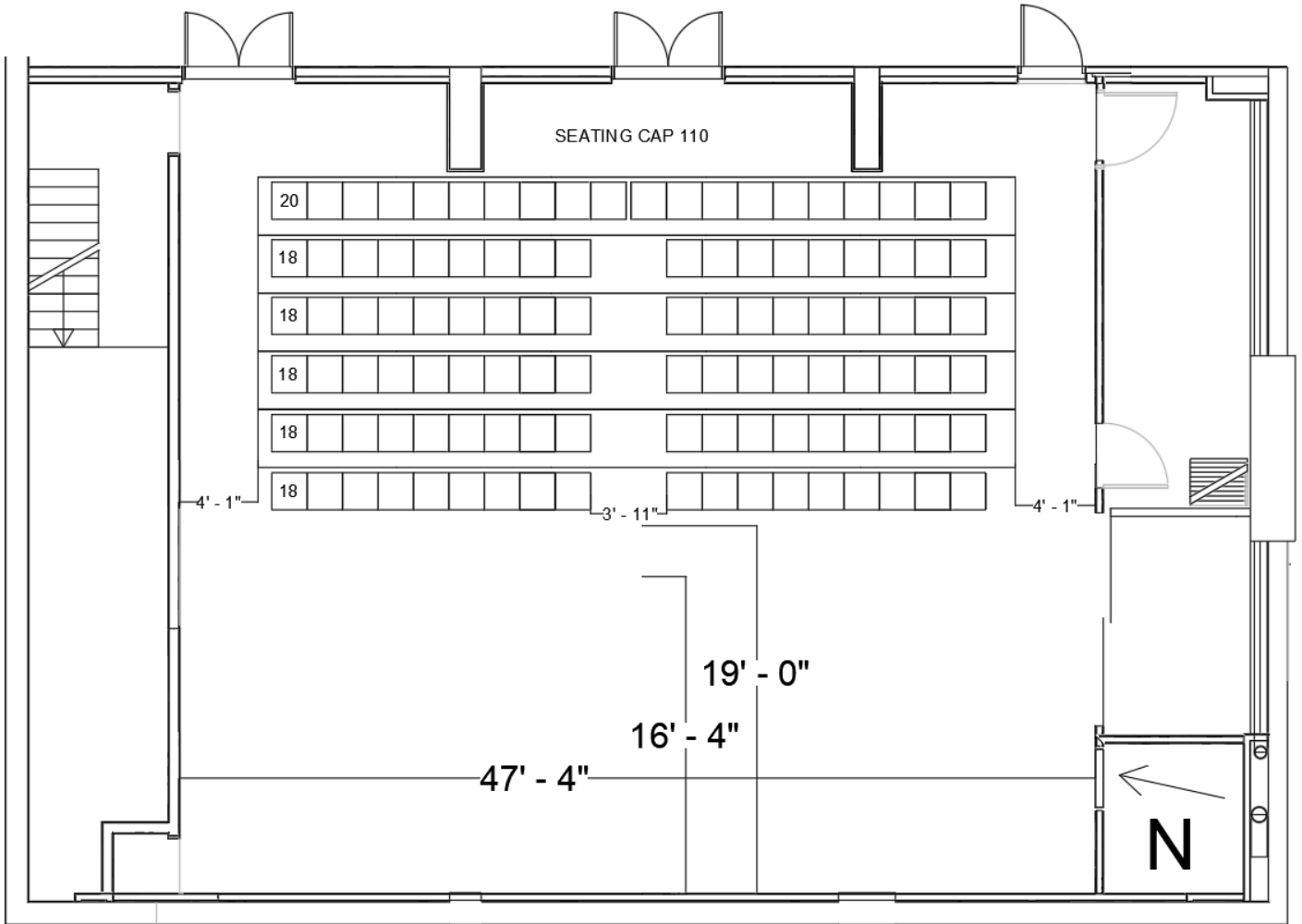

THRUST

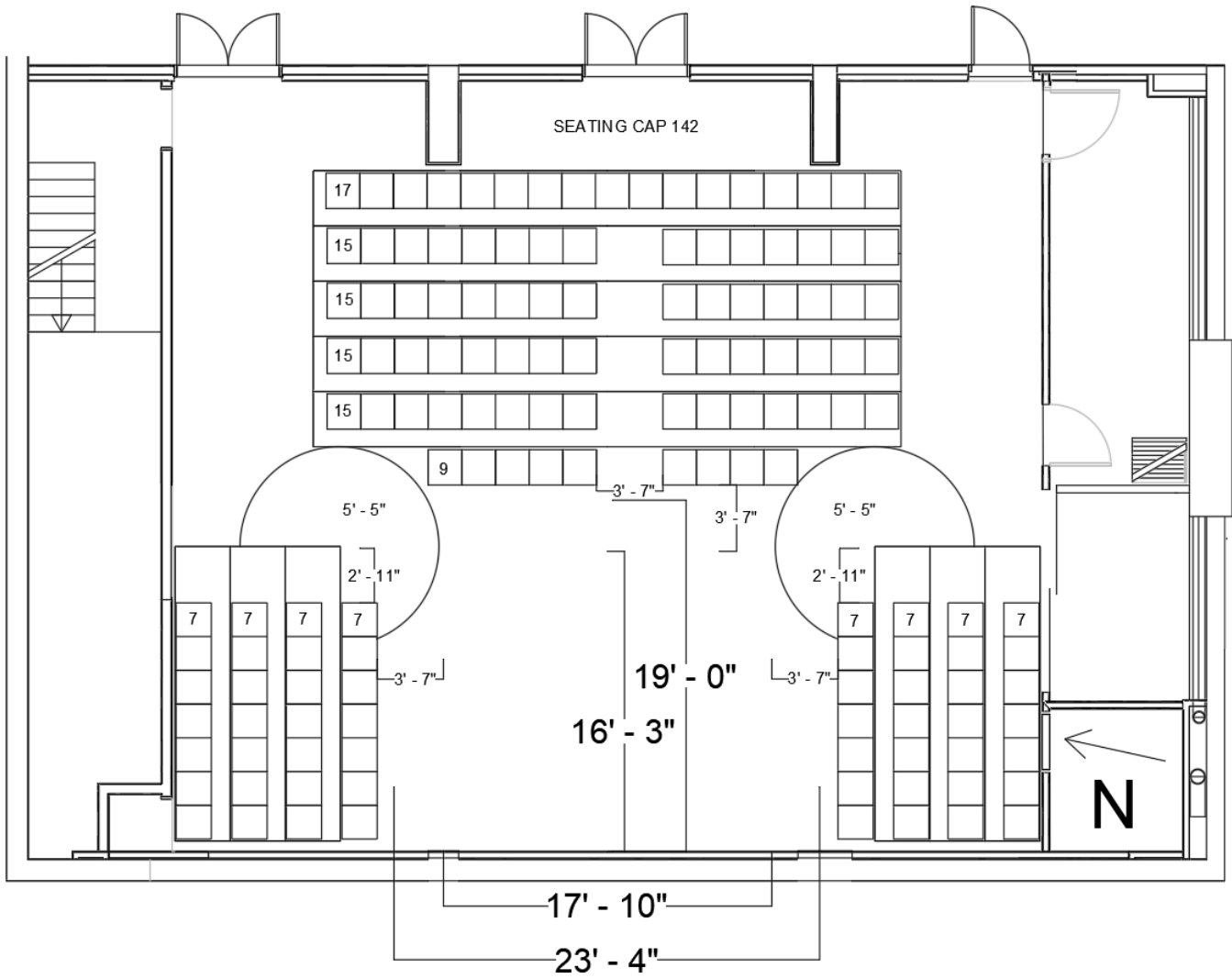

FLAT FLOOR

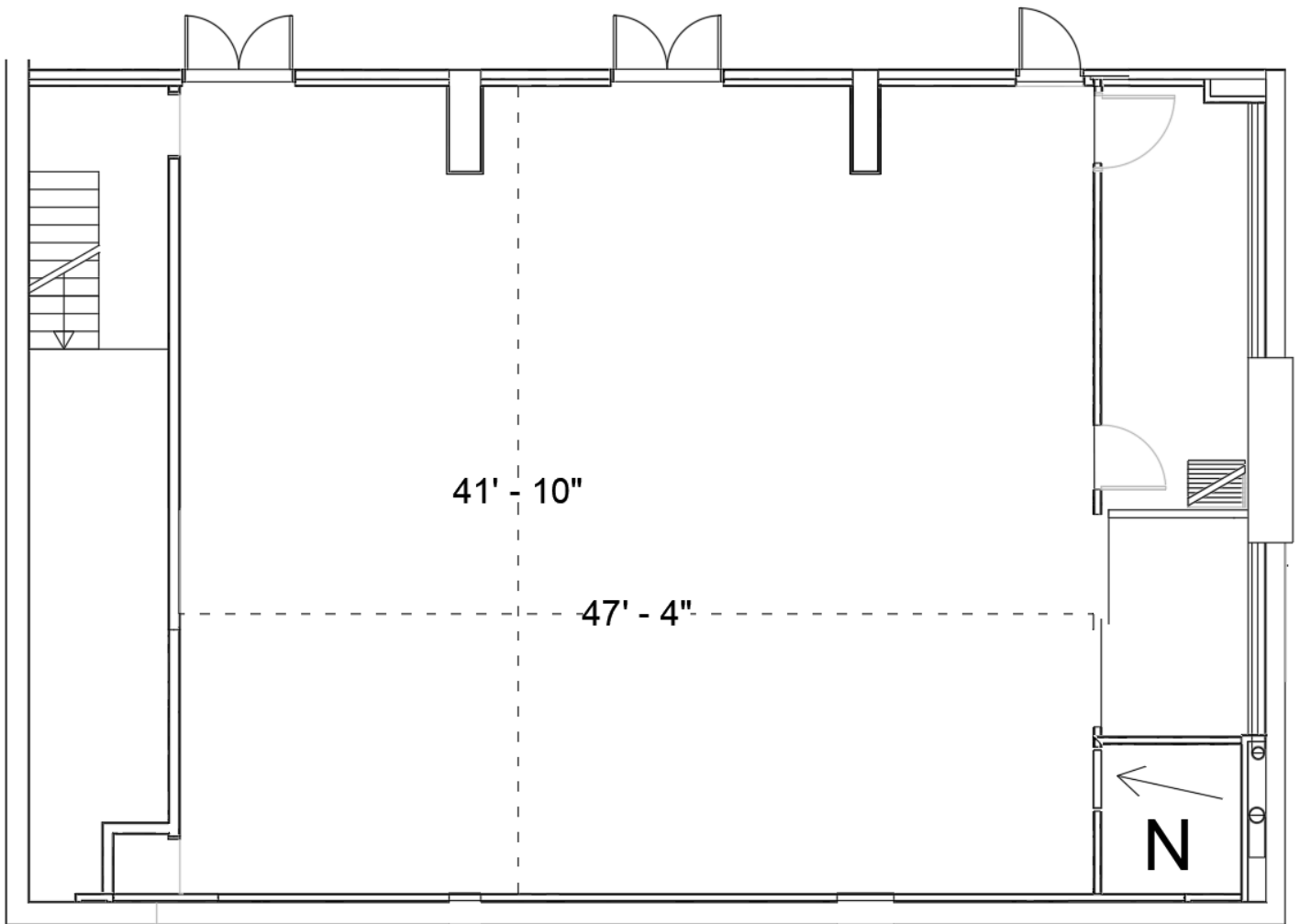

FLOORING

Hardwood Floor, bright birch wood. Floor construction Junckers Clip Sports Floor System is based on 22 mm solid hardwood floorboards installed as a floating floor with steel clips on a 10 or 15 mm resilient foam underlay.

Performance:

The floor system is categorized as an area elastic sports floor with medium shock absorbency and elasticity particularly suitable for fitness and aerobics as well as in refurbishment projects.

The floor system is tested and approved according to:

- The European Sport Norm EN 14904 class A3, when using Junckers 10 mm SportsFoam
- FIBA level 2, when using Junckers 15 mm Sports Foam.

Step sound reduction by installation on heavy constructed horizontal divisions:

22 mm □ floorboards on 10 mm SportsFoam underlay: 18 dB.

RIGGING

The Fixed Grid has the following ratings:

System Load @ 50lbs / Lft.

Point Load @ 200 lbs

Please coordinate with Venue staff and House Technicians to ensure your rigging needs can be met. (additional ceiling points can be installed @ \$950 / point. Ceiling Space is not guaranteed.

LABOUR

NEJPC is a non-unionized venue. In the absence of a union the venue manages booking of all technical staff and crew from a robust list of freelance professionals in the GTA.

When a House Technician is under billable hours the rate is \$33/hr. OT after 40 across a Calendar Week.

When a department head/specialist/rigger is called under billable hours the rate is \$30/hr.

When a non-departmental crew person is called under billable hours the rate is \$28/hr

Crew will work no longer than 5 consecutive hours without taking a meal break.

WORKING HOURS & PROCEDURES

Standard Operating hours are as follows:

Non-show calls - 09:00-18:00

4:1:4 day. 4hrs of work, 1hr break, 4hrs of work

Show calls - 09:00-23:00 (show calls are 4.5hr minimums)

4:1:4:1/2:4.5 day. 4hrs of work, 1hr break, 4hrs of work, 30 min break, 4.5hr show call

AUXILIARY SPACES

Nancy & Ed Jackman Performance Centre has a limited selection of Auxiliary Spaces that are available to our various renters.

GREEN ROOM

The Green Room is on the East side of the corridor, between the box office and concession stand. The room is approx. 20' x 16'. Equipped with small kitchenette, island, dining table, couch and armchair, and equity cot (available upon request)

REHEARSAL HALL [DRESSING ROOM(S)]

The Rehearsal Hall is a mirrored and multi-functional space. The room is approx. 19' x 38'. It contains a water closet with a small shower, 16ft of mirrored wall, a small technical kit, passage to the main corridor and the green room, and a dressing room kit.

The dressing room kit of tables, vanity table-tops, chairs, and pipe and drape to create 2 only semi-private spaces @ approx. 8' x 19' & 14' x 12'.

SALON & LAUNDRY

The Salon and Laundry room is a meeting room and a potential workspace. The room is approx. 16' x 10'. It is equipped with a small stacking washer and dryer, as well as a built-in worksurface/ stationary rack, and a meeting desk suitable for 8 people.

BOX OFFICE, CONCESSION & HOT DESK(S)

These FOH and flexible positions are small single occupant stations equipped with millwork and a roll down-lockable door.

PROGRAM SOUND & VIDEO

There is Program Sound in the main corridor, rehearsal hall (dressing rooms), and the green room.

WIFI

Wifi is available for renters of the space. Contact Staff for up to date passwords and network names.

KEY POLICIES

Please reference below for some policy positions commonly requested by guests.

CATERING

There are no catering restrictions in this venue. Please collaborate with Staff regarding your catering plans.

ARCHIVALS

Archival recordings are permitted in the venue. Single camera lock-offs can be arranged between guests, the Director of Facilities & Production, and FOH management.

FILMING & PHOTOGRAPHY

Filming digital content is not permitted unless done so expressly in person or by memo from NEJPC staff.

FIREARMS

NEJPC is a firearm free venue. No blank-firing devices, decommissioned arms, props, or approximations of firearms will be permitted on the premises.

FLAME

The use of open flame at NEJPC is prohibited, including reception candles and sterno burners for catering. The use of chaffing gel is allowed with permission from the Director of Facilities & Production.

INVENTORIES

DRAPES, PIPE, PROPERTIES & PIANOS

Drapes:

1 set - Performance Hall Curtain Surround
10@ 6ft wide x Grid Height Legs w/ alum.batten

Pipe Stock:

08x 13' - 2" black alu pipe "Floor to Grid"
08x 8' - 0" black alu pipe "Add pipe"
10x 6' - 0" black alu pipe "Leg Battens"

Properties:

2@ 24" cocktail rounds
Folding tables w/ table cloth

Pianos:

Performance Hall
 Imperial Bosendorfer Grand Piano
 Baldwin Upright Piano
Rehearsal Studio
 Yamaha Upright Piano

LIGHTING (most instruments are in use in the House Plot)

ETC Ion XE Lighting Control Desk

68@ ETC Source 4 Lustr 2 Light Engine w/ Shutters

9@ S4 36 degree lens

43@ S4 50 degree lens

20@ S4 70 degree lens

8@ S4 drop-in Iris

16@ S4 Top hat

16@ ETC Source 4 Lustr 2 Light Engine

16@ S4 Fresnel lens (2-6 used for house lighting)

8@ S4 Cyc lens

5+1@ Elation Fuze Profile Moving Head - FUZ495

AUDIO

Allen & Heath SQ-6 Audio Console w/ 64x64 Dante Card
Allen & Heath DT-168 Stage Box 16x8

8@ D&B 12S Loudspeaker
2@ D&B 27S Subwoofer
4@ D&B 5S Loudspeaker

Mac Mini M2 playback machine (audio & video)

4@ Shure SM58
4@ Shure SM57
2@ Shure SM 81-lc
4@ Radial JDI - DI Box
4@ Radial J48 active - Di Box

VIDEO

1x NEC NP-PA803UL - 8k Projector
1x NEC NP41ZL - F1.7-2.0 Standard Lens
1x Mount

2x OPTOMA WU515TST - 5K Projector

ATEM Mini Extreme
8@ Bird Dog HDMI to NDI encoder

PLOTS

[Link to House Lighting and Sound Plot](#)

MAGIC SHEET

[Link to House Magic Sheet](#)

KEY SCHEDULES

[Link to Channel Hook-up](#)